

installation instructions

Dual Fuel Electrical Elements

Components

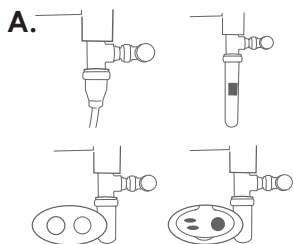

1 x Electrical Element

B.

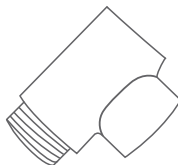

1 x T Piece

Tools Required (not supplied)

- Adjustable Spanner
- PTFE Tape

Important Information

PLEASE READ THESE INSTRUCTIONS THOROUGHLY BEFORE STARTING INSTALLATION.

THE TOWEL WARMER OR RADIATOR WILL GET VERY HOT SO IT IS NOT SUITABLE FOR USE IN LOCATIONS WHERE THIS COULD BE A HAZARD.

THIS PRODUCT MUST BE INSTALLED BY A COMPETENT PERSON IN ACCORDANCE WITH IEE WIRING REGULATIONS.

IT MAY BE NECESSARY TO NOTIFY YOUR LOCAL AUTHORITY BUILDING CONTROL DEPARTMENT OR HAVE THE WORK DONE BY A QUALIFIED ELECTRICIAN.

NEVER SWITCH THE HEATING ELEMENT ON UNLESS IT IS FULLY INSTALLED AND COMPLETELY COVERED BY WATER. THE HEATING ELEMENT WILL BE DESTROYED IF IT IS ALLOWED TO OPERATE IN AIR.

THE HEATING ELEMENT IS NOT SUITABLE FOR INSTALLATION IN THE TOP OF A TOWEL WARMER OR RADIATOR.

PLEASE ENSURE THAT YOU WEAR ALL NECESSARY PERSONAL PROTECTIVE EQUIPMENT FOR YOUR SAFETY.

Please check that all components are present and that you are ENTIRELY happy with the size, design and finish BEFORE starting installation.

Due to our commitment to continuous product development we reserve the right to alter specifications without notice. Products are guaranteed against manufacturing defects for the first purchaser only and the guarantee is non-transferable. Our liability under any guarantee expressed or implied is strictly limited to replacement of defective goods or a refund at our discretion and no consequential losses will be entertained. Proof of purchase will be required.

Note: For operating instructions of regulator, thermostatic or infrared, please see the separate instruction leaflet

Step 1

Check that the heating element is suitable for the towel warmer or radiator that you intend to install into.

Step 2

Switch off the electrical supply at the mains. We recommend that the fuse is removed or the circuit breaker switched off at the fuse box.

Step 3

In most cases, the heating element must be fitted to the towel warmer or radiator before it is mounted onto the wall.

Step 4

Wrap a thick layer of PTFE tape around the heating element thread and the T piece thread. Check that the O ring is present on the heating element thread.

Step 5

Screw the T piece onto the heating element and tighten into place.

Step 6

Screw the heating element and T piece into the towel warmer or radiator and tighten so that the T piece outlet is in the correct position. **THE HEATING ELEMENT MUST ONLY BE FITTED VERTICALLY AND IN THE BOTTOM OF THE TOWEL WARMER OR RADIATOR.**

Step 7

Mount the towel warmer or radiator on the wall in accordance with the installation instructions supplied. Fit the radiator valves and connect the central heating pipes in accordance with the instructions supplied.

Step 8

The system should be thoroughly flushed using a central heating cleanser that is approved by the Domestic Water Treatment Association. Chemically flushing the system is essential to clean out any debris or chemicals that may have been introduced. **DO NOT FLUSH WITH WATER ONLY AS THIS WILL INVALIDATE THE GUARANTEE.**

Step 9

The system should be filled and a Domestic Water Treatment Association approved central heating protector added. A protector will improve efficiency and the life cycle of the entire central heating system. **FAILURE TO PROTECT THE SYSTEM PROPERLY WILL INVALIDATE THE GUARANTEE.**

Step 10

Open the radiator valves and purge any air from the system through all air vent plugs on all towel warmers and radiators.

Step 11

Connect the Heating Element to a BS Fused Connection Unit which should be fitted with a 5 Amp fuse. **THIS PRODUCT MUST BE EARTHED.**

Step 12

Switch the electrical supply back on and test the heating element. The towel warmer or radiator should heat up. **THE RADIATOR VALVES MUST BE LEFT OPEN AT ALL TIMES WHEN THE HEATING ELEMENT IS SWITCHED ON.**

Care and Maintenance

Air should be purged from the towel warmer or radiator after the central heating system has been operated at full temperature. We would also recommend checking for air at least twice per year.

AFTER INSTALLATION THE CENTRAL HEATING SYSTEM MUST BE THOROUGHLY FLUSHED WITH A DOMESTIC WATER TREATMENT ASSOCIATION APPROVED CENTRAL HEATING CLEANSER.

FOLLOWING CLEANSING A DOMESTIC WATER TREATMENT ASSOCIATION APPROVED CENTRAL HEATING PROTECTOR MUST BE ADDED TO THE SYSTEM. FAILURE TO PROPERLY CLEANSE AND PROTECT THE SYSTEM WILL INVALIDATE THE GUARANTEE AND IS LIKELY TO CAUSE SMALL PINHOLE LEAKS.

NEVER SWITCH THE HEATING ELEMENT ON IF THE TOWEL WARMER OR RADIATOR IS EMPTY.

For technical support or advice please call your merchant.