

Bath Filler Waste EZ Clean Installation

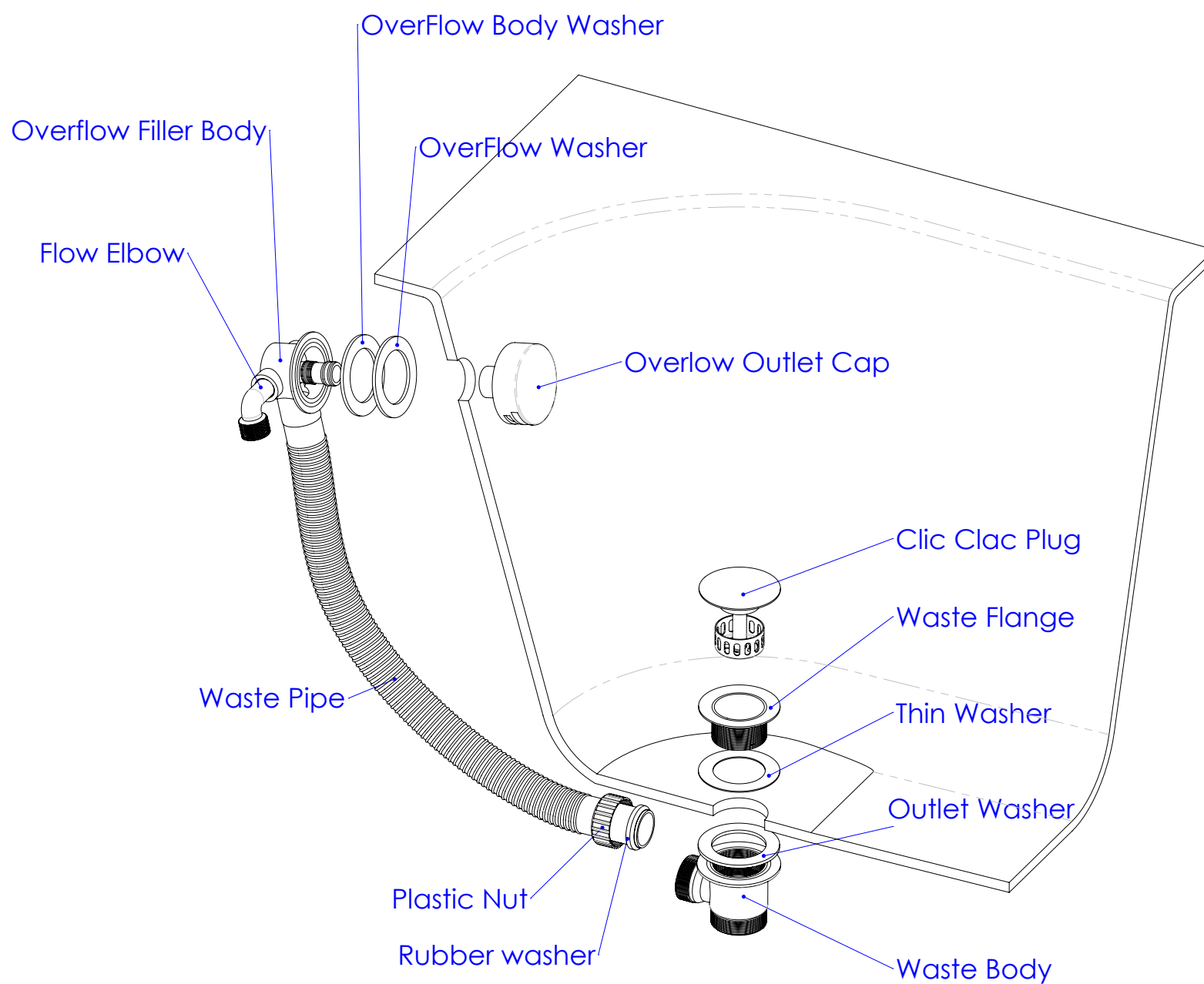

Installation

1. Carefully unscrew and remove the Overflow Outlet Cap from the Overflow Filler Body .
2. Carefully unscrew and remove the Waste Flange from the Waste Body.
3. Offer the Waste Body to the bath and secure in place with the waste flange ensuring the washers are correctly positioned.
4. Offer the Overflow filler body to the overflow of the bath and secure in place using the Overflow Outlet Cap ensuring the o-washers are in place.
5. Connect the waste pipe and tighten the Plastic Nut .
6. Connect the flow to the Flow Elbow using an appropriate connector.
7. Test for leaks by filling the bath with the plug in place.
8. Test for inlet leaks.